

Issue	By	Issue Description	Date
BL2	SA	ISSUE FOR BUILDING LICENCE.	10/09/12
BL3	SA	ISSUE FOR BUILDING LICENCE.	26/09/12
C	SA	ISSUE FOR CONSTRUCTION.	16/10/12

- NOTES**
- BUILDER TO CHECK ALL DIMENSIONS ON SITE PRIOR TO COMMENCING CONSTRUCTION.
 - ARCHITECTURAL DRAWINGS ARE TO BE READ IN CONJUNCTION WITH ALL RELEVANT CONSULTANTS DRAWINGS.
 - ALL BUILDING WORKS TO BE EXECUTED IN ACCORDANCE WITH AUSTRALIAN STANDARDS, BUILDING CODE OF AUSTRALIA, LOCAL & REGULATORY AUTHORITIES.
 - BUILDER TO NOTIFY ARCHITECT IMMEDIATELY OF ANY SERVICE LOCATION DISCREPANCIES OR CLASHES ON SITE. NO WORK TO COMMENCE UNTIL APPROVAL BY ARCHITECT IS GRANTED.
 - ALL EXTERNAL CLADDING, DOORS, WINDOWS ETC. MUST BE CAPABLE OF RESISTING THE ULTIMATE WIND PRESSURES AND IMPACT LOADS AS DEFINED IN AS 1170. REFER TO STRUCTURAL DRAWINGS FOR SITE DESIGN PARAMETERS.
 - CYCLONIC FIXING: ALL EXTERNAL ROOF / WALL SHEETING, WINDOWS / DOORS, BALUSTRADES / SCREENS, FENCES ETC., TO BE FIXED TO MEET REQUIREMENTS OF AS 1170. REFER TO MANUFACTURERS RECOMMENDATIONS / FIXING DETAILS TO SUIT THIS WIND REGION (REGION D, TERRAIN CATEGORY 2).

WALL LEGEND

CODE	DESCRIPTION
---	NOMINAL 100mm THICK, 64mm STEEL STUD FRAMED WALL SYSTEM. 13mm FLUSHED PLASTER BOARD TO BOTH SIDES. SELECTED PAINT FINISH OVER.
---	NOMINAL 120mm THICK, 92mm STEEL STUD FRAME WALL SYSTEM. EXTERNAL FACE LINED WITH CUSTOM ORB COLORBOND WALL SHEETING. INTERNAL FACE LINED WITH 13mm FLUSH PLASTER BOARD.
---	INSULATION: AIR-CELL INSUL BREAK 65 INSULATION MEMBRANE / SARKING TO EXTERNAL FACE OF WALL. R2.7 GOLD HIGH PERFORMANCE WALL BATTS. SELECTED PAINT FINISH OVER.
---	NOMINAL 150mm THICK STEEL STUD FRAME WALL SYSTEM. CSR 050 92mm STUD FRAMING WITH 1x13mm GYROCK FYRCHCK TO BOTH SIDES & CUSTOM ORB TO EXTERNAL FACE.
---	NOMINAL 155mm THICK STEEL FRAMED FIRE WALL. CSR 122 (90/90/90) FR EXTERNAL WALL SYSTEM. 92mm STUD FRAMING WITH ACR 15% & 1x16mm GYROCK FYRCHCK TO BOTH SIDES & CUSTOM ORB TO EXTERNAL FACE.
---	INSULATION: AIR-CELL INSUL BREAK 65 INSULATION MEMBRANE / SARKING TO EXTERNAL FACE OF WALL. R2.7 GOLD HIGH PERFORMANCE WALL BATTS. SELECTED PAINT FINISH OVER.
---	190MM BLOCKWORK WITH RENDERED FINISH. SELECTED PAINT FINISH OVER.
---	NOMINAL 140mm THICK STEEL FRAMED FIRE WALL. CSR 046 (90/90/90) FR INTERNAL WALL SYSTEM. 92mm QUIETSTUD FRAMING WITH ACR15% & 1x 6mm GYROCK FYRCHCK TO ONE SIDE & 1x 6mm CEMINTEL WALLBOARD THE OTHER. R2.7 GOLD HIGH PERFORMANCE WALL BATTS. SELECTED PAINT FINISH OVER.
PLUMBING DUCT	METAL STUD FRAMING WITH 2x13mm GYROCK FYRCHCK & CUSTOM ORB TO EXTERNAL FACE.

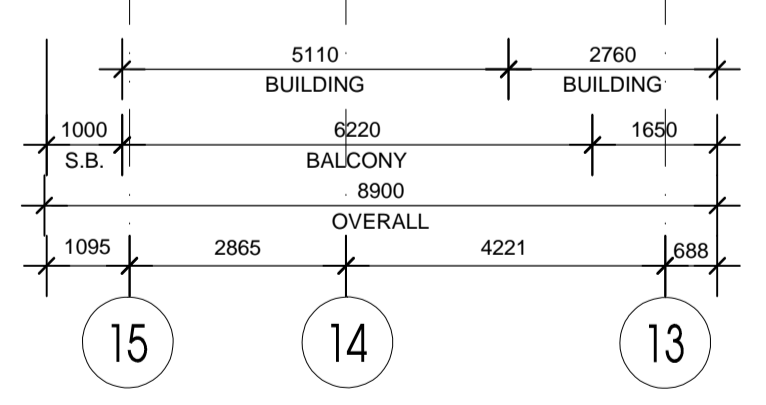
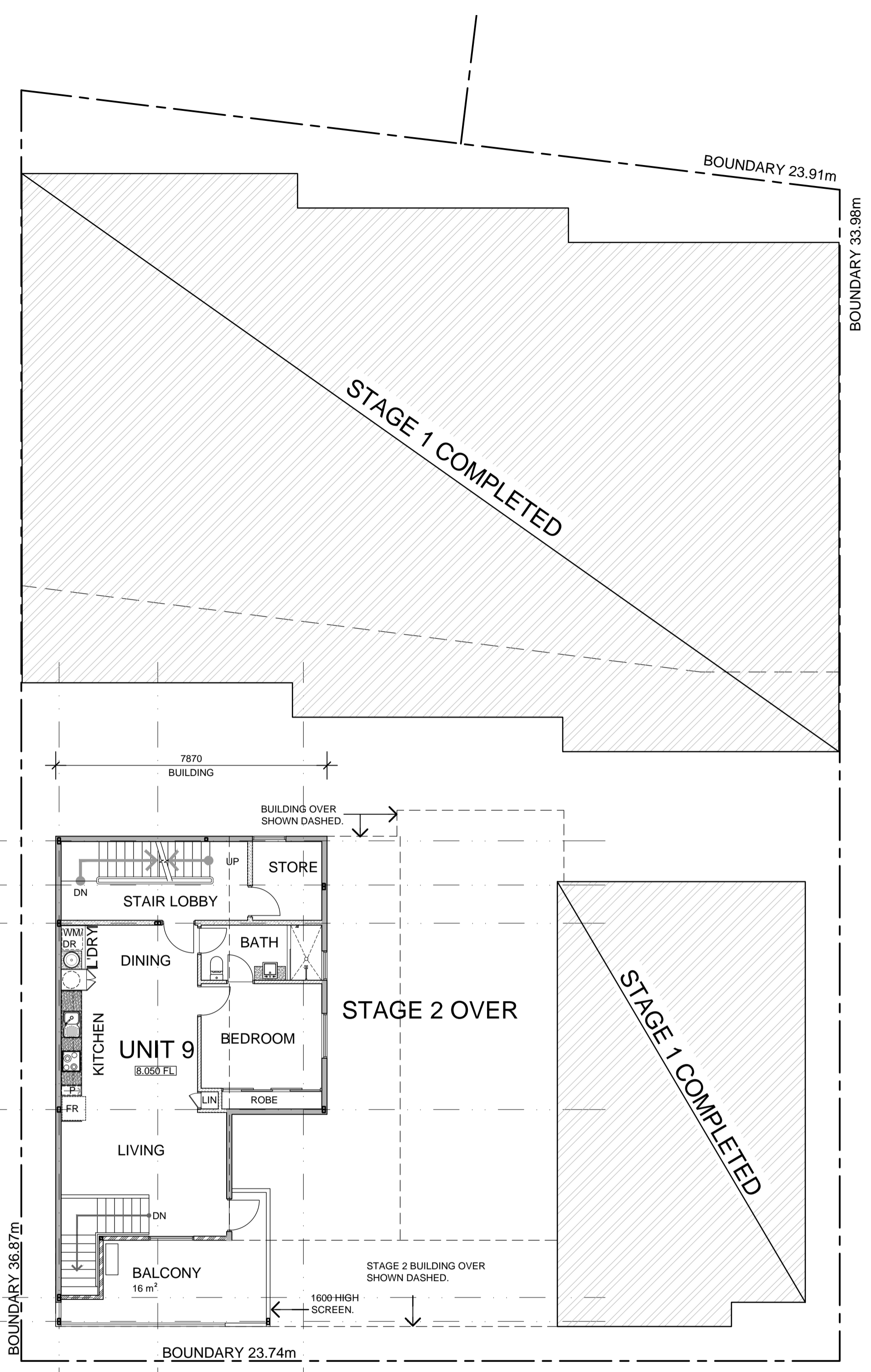

FIRST FLOOR PLAN

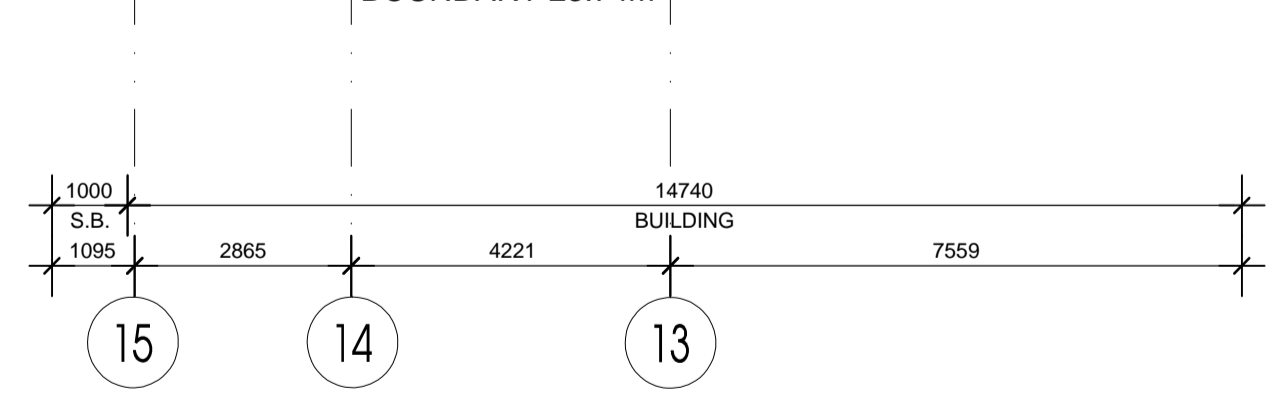
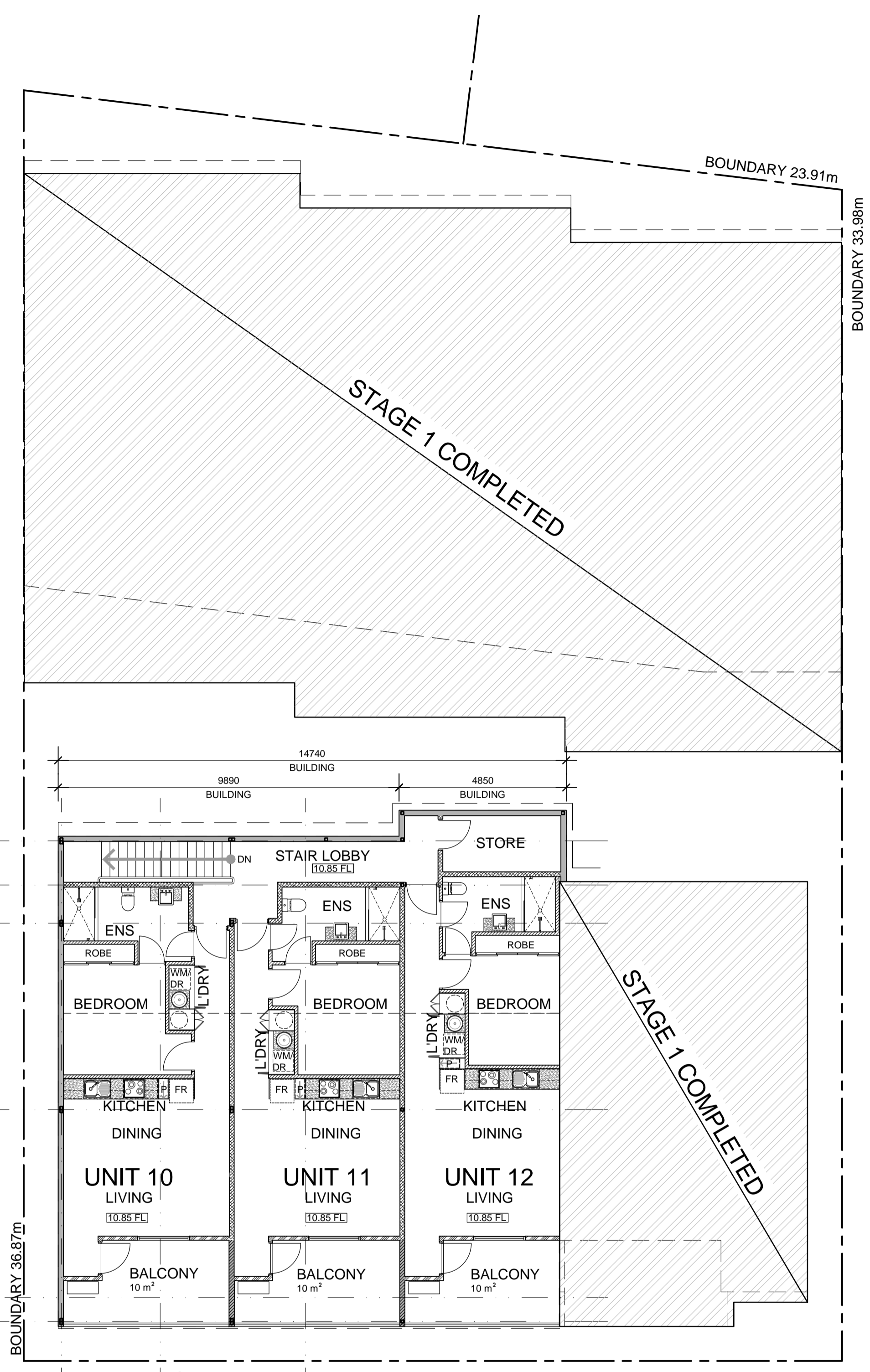

SECOND FLOOR PLAN

DOEPEL MARSH architects

61 Forrest St, Subiaco Western Australia 6008
 PO Box 308 Subiaco WA 6904
 T + 61 8 9388 2281 F + 61 8 9388 3162
 License No. 2038 E admin@doepelmarsh.com.au
 ABN 73 883 655 197 W www.doepelmarsh.com.au

Project Name
RESIDENTIAL DEVELOPEMENT

50 MORGAN ST
 PORT HEDLAND

Title
FIRST & SECOND FLOOR PLAN

Scale 1:100 Date **JUNE 2012**

Drawn SA & JB	Checked CR	Coord. CR	Approved
---------------	------------	-----------	----------

Project Number **10.47** Drawing Number **A122** Issue **C**

DO NOT SCALE FROM THIS DRAWING. THIS DRAWING IS FOR READING PURPOSES ONLY.

© Copyright. THIS DRAWING REMAINS THE PROPERTY OF DOEPEL MARSH ARCHITECTS PTY. LTD. AND SHALL NOT BE COPIED OR USED WITHOUT PRIOR WRITTEN AUTHORISATION.